

**SITE DATA TABULATION**

OWNER: NEW HANOVER COUNTY BOARD OF ED.  
 PROJECT ADDRESS: 4412 LAKE AVENUE  
 WILMINGTON, NC 28403  
 TAX PARCEL IDENTIFICATION #: R06110-001-002-000 (28.01 AC)  
 RECORDED DEED BOOK: BR 0683, PG 648331  
 BR 660, PG 592  
 BR 1529, PG 1089  
 BR 5351, PG 2809  
 20.43 ACRES (989,713 SF)  
 OR#1 - OFFICE & INSTITUTIONAL DISTRICT 1  
 URBAN  
 4S  
 BLDG. A=24', BLDG. B=24', BLDG. C=12',  
 BLDG. D=12'  
 MIDDLE SCHOOL  
 MIDDLE SCHOOL  
 MIDDLE SCHOOL

**TOTAL SITE AREA:**  
 CURRENT ZONING: OR#1 - OFFICE & INSTITUTIONAL DISTRICT 1  
 MAXIMUM ALLOWABLE BUILDING HEIGHT: 45'  
 EXISTING LAND USE: MIDDLE SCHOOL  
 PROPOSED LAND USE: MIDDLE SCHOOL

**SETBACK STANDARDS**

PROVIDED	REQUIRED
MINIMUM FRONT SETBACK: 150.5 FT. (NORTH)	20 FT.
MINIMUM SIDE SETBACK: 254.5 FT. (EAST)	10 FT.
MINIMUM SIDE SETBACK (ADJACENT TO RESIDENTIAL ZONING): 125.7 FT. (WEST)	20 FT.
MINIMUM REAR SETBACK: 661.5 FT. (SOUTH)	20 FT.

**SITE INFORMATION**

LOT AREA	15,000 SF
LOT WIDTH	80' MIN.
BLDG LOT COVERAGE	49% MAX.

**BUILDING INFORMATION**

EX. CONSTRUCTION TYPE:	CONCRETE ONGR
BLDG A	118
BLDG B	118
BLDG C	118
BLDG D	118

**EXISTING BUILDING FOOTPRINT SF**

BUILDING A	20,465 SF (2-STORY)
BUILDING B	43,500 SF (1-STORY)
BUILDING C	2,582 SF (1-STORY)
BUILDING D	3,950 SF (1-STORY)
<b>TOTAL:</b>	<b>68,500 SF</b>

**PROPOSED BUILDING ADDITIONS**

BUILDING A	111 SF
BUILDING B	0 SF
BUILDING C	364 SF
BUILDING D	23,745 SF
TEMPORARY MODULARS (3)	8,856 SF
PERMANENT MODULAR (1)	33,076 SF
<b>TOTAL:</b>	<b>66,052 SF</b>

**SITE PARKING**

MINIMUM PARKING REQUIRED: (1 PER TEACHER AND STAFF PERSON, 80 STAFF MEMBERS)	80 SPACES
MAXIMUM PARKING ALLOWABLE:	120 SPACES
TOTAL PARKING PROVIDED:	117 SPACES
HANDICAP PARKING REQUIRED:	5 SPACES
HANDICAP PARKING PROVIDED:	8 SPACES
BICYCLE PARKING REQUIRED:	10 SPACES (EXISTING)
BICYCLE PARKING PROVIDED:	20 SPACES (EXISTING)

**IMPERVIOUS AREA:**

EXISTING IMPERVIOUS AREA BUILDINGS	70,497 SF
EXISTING IMPERVIOUS AREA SIDEWALK & DRIVEWAY	154,819 SF
PROPOSED IMPERVIOUS AREA TO BE DEMOLISHED	225,316 SF (25.3%)
PROPOSED IMPERVIOUS AREA PERMANENT	30,361 SF (3.41%)
PERMANENT SIDEWALK	4,806 SF
PERMANENT DRIVEWAY	3,088 SF
MOBILE UNIT	8,856 SF
TEMPORARY SIDEWALK	16,550 SF (1.86%)
MOBILE UNITS	1,378 SF
	23,745 SF
	25,123 SF (2.82%)

**NEW HANOVER COUNTY BOARD OF EDUCATION**  
 PARID: R06110-001-002-000  
 D.B. 1914, PG. 532  
 4412 LAKE AVENUE  
 EDUCATIONAL ZONING: OR#1

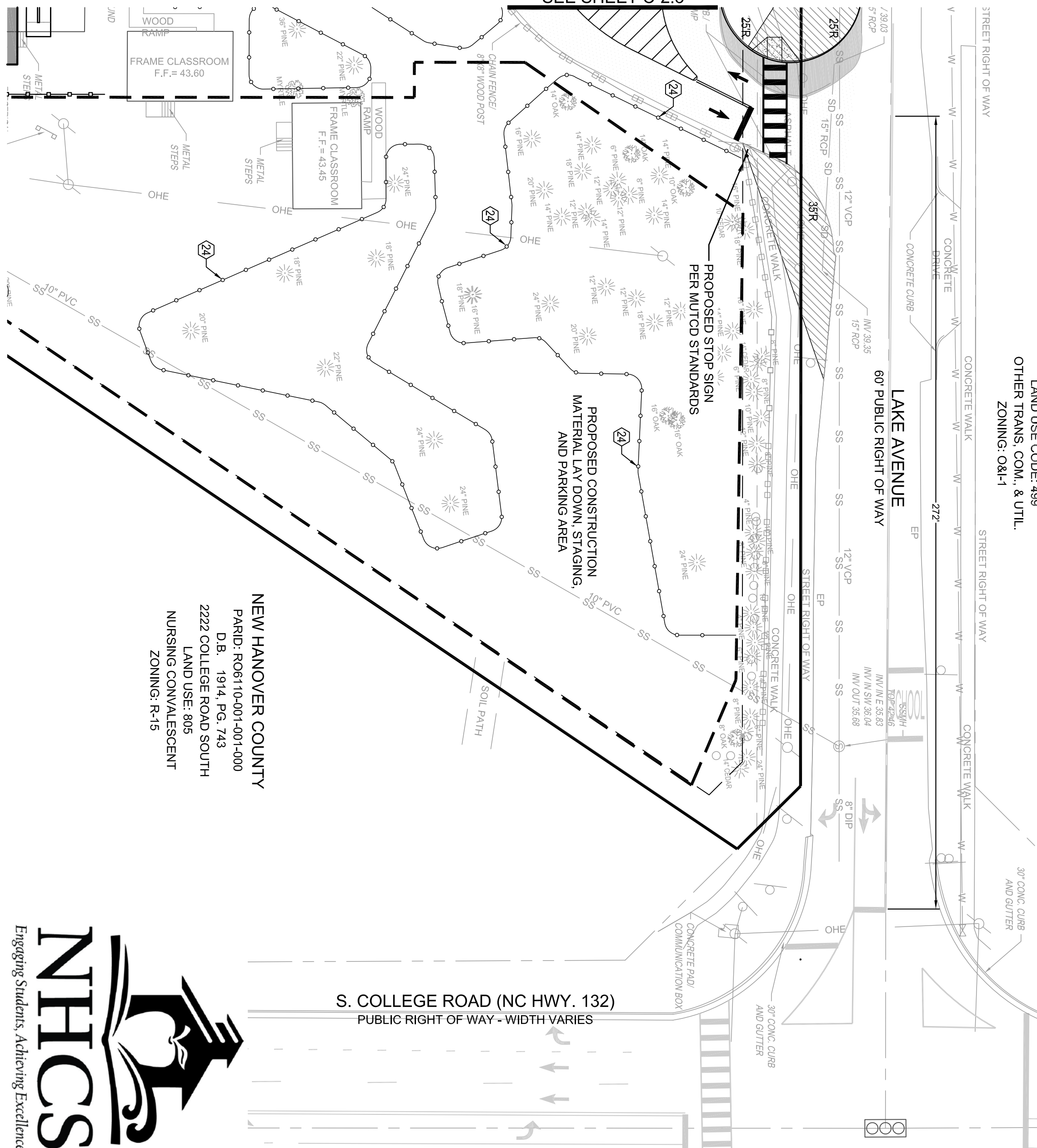
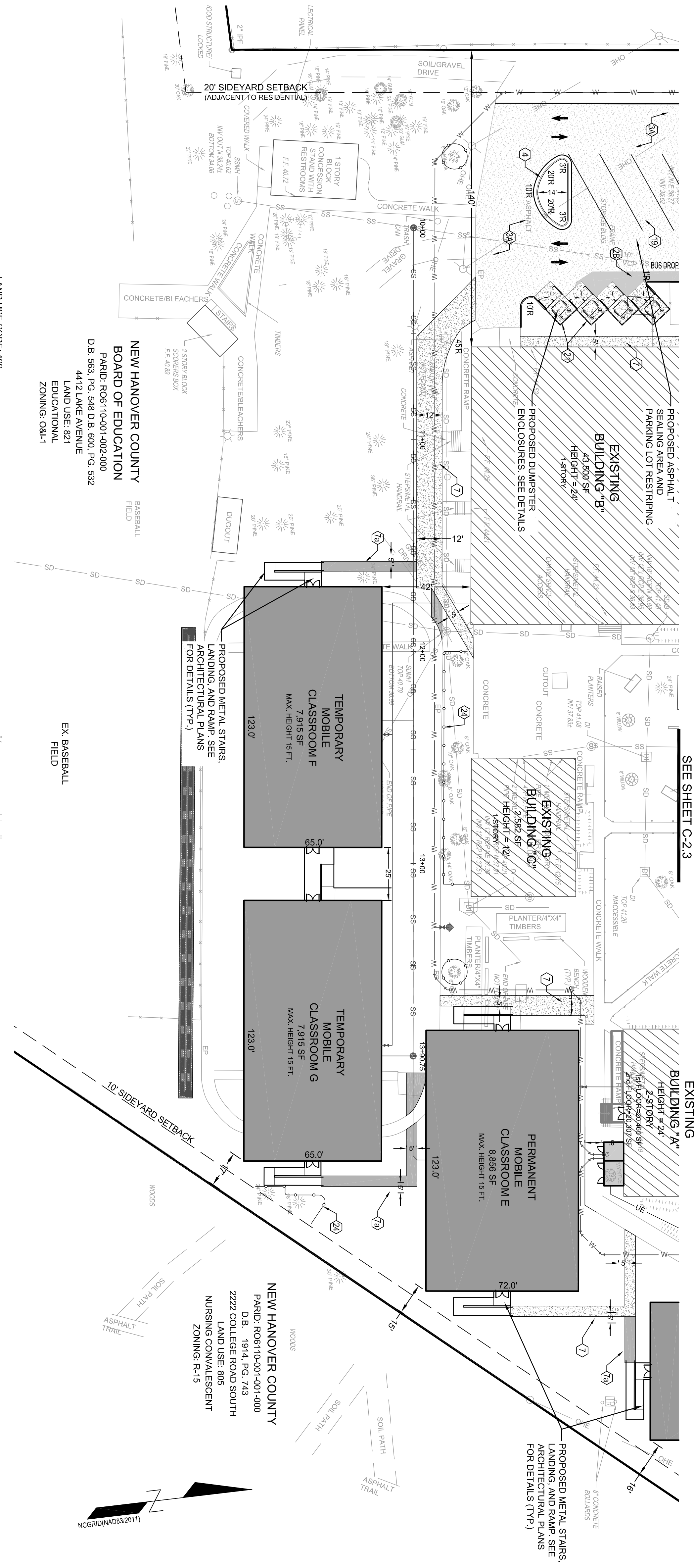

**KEY NOTES:**

- CONCRETE PAVING: REFER TO DETAIL C-5.0
- LIGHT DUTY ASPHALT PAVING: REFER TO DETAIL C-5.0
- PENULOUS CONCRETE: REFER TO DETAIL C-5.0
- ASPHALT OVERLAY AREA: REFER TO DETAIL C-5.0
- ASPHALT SEAL COAT: REFER TO TECHNICAL SPECIFICATIONS
- STANDARD 24\"/>
- TRANSITION CURB DETAIL: SEE DETAIL C-5.0
- CONCRETE SIDEWALK: REFER TO DETAIL C-5.0
- ASPHALT SIDEWALK: REFER TO DETAIL C-5.0
- CONCRETE DOOR LANDING: SEE ARCHITECTURAL
- EXPOSED FACE CONCRETE SIDEWALK TO ASPHALT DETAIL: SEE DETAIL C-5.0
- STEEL BOLLARD: REFER TO ARCHITECTURAL DRAWINGS
- HANDICAP PARKING SIGN: REFER TO DETAIL C-5.0
- DETECTABLE WARNING MAT: REFER TO DETAIL C-5.0
- HANDICAP PARKING SYMBOL: REFER TO DETAIL C-5.0
- HANDICAP ACCESS UNLOADING ZONE: 24\"/>
- STRIPING: REFER TO ARCHITECTURAL DRAWINGS
- STRIPING AS SHOWN: REFER TO ARCHITECTURAL DRAWINGS
- EMERGENCY VEHICLE LANE MARKING: NOT APPLICABLE
- PROPOSED DUMPSTERS & ENCLOSURE: REFER TO DETAILS C-5.0 & C-5.1
- CONCRETE DRIVE ARRANG (COMMERCIAL): REFER TO C-2.4 FOR COORDINATE PLAN AND STRUCTURAL AND ELECTRICAL FOR TYP. DETAILS
- MAN GATE: SEE ARCHITECTURAL DRAWINGS FOR DETAILS
- ORNAMENTAL FENCING: REFER TO DETAIL C-5.0
- TREE PROTECTION FENCING: SEE DETAIL C-2.3
- PLYON SIGN: REFER TO ARCHITECTURAL DRAWINGS
- CONCRETE DRIVE ARRANG (COMMERCIAL): REFER TO C-2.4 FOR COORDINATE PLAN AND STRUCTURAL AND ELECTRICAL FOR TYP. DETAILS

**LEGEND:**

- Proposed Asphalt Overlay
- Proposed Asphalt Sealing
- Proposed Asphalt Section
- Proposed Building
- Proposed Concrete
- Proposed Chain Link Fence
- Existing Tree Line
- Proposed Light Pole
- Proposed Landscape Island
- Proposed Tree Protection Fence
- Parking Space Count
- Proposed Contractor Laydown Area

**APPROVED CONSTRUCTION PLAN**

Public Services - Engineering Division  
 APPROVED STORMWATER MANAGEMENT PLAN

Date: \_\_\_\_\_ Permit # \_\_\_\_\_

Signed: \_\_\_\_\_

Name \_\_\_\_\_ Date \_\_\_\_\_

**Know what's below. Call before you dig.**

For each open utility cut of City streets, a \$325 permit shall be required from the City prior to occupancy, and/or project acceptance.

NCDENR PWSS WATER PERMIT #: \_\_\_\_\_  
 WATER CAPACITY: \_\_\_\_\_  
 DIVO SEWER PERMIT #: \_\_\_\_\_  
 SEWER CAPACITY: \_\_\_\_\_  
 SEWER SHED # AND PLANT: \_\_\_\_\_  
 SEWER TO FLOW THROUGH NEI: YES or NO (CIRCLE ONE)

GRAPHIC SCALE: 1"=40'

SCALE: 1"=40'

**FINAL DESIGN - NOT RELEASED FOR CONSTRUCTION**

<p>PEL JOB#: 17215.PE</p> <p><b>C-2.2</b></p> <p>06/18/18</p>	<p><b>PROJECT STATUS</b></p> <p>CONCEPTUAL LAYOUT:          PRELIMINARY LAYOUT:          FINAL DESIGN:          RELEASED FOR CONST:</p> <p><b>DRAWING INFORMATION</b></p> <p>DATE: 05/28/18          SCALE: 1" = 30'          DESIGNED: RBB          DRAWN: RBB          CHECKED: RBB</p>	<p><b>SITE PLAN</b></p> <p>ROLAND GRISE MIDDLE SCHOOL          4412 LAKE AVENUE          WILMINGTON, NORTH CAROLINA</p>	<p><b>PARAMOUNT ENGINEERING</b></p> <p>122 Cinema Drive          Wilmington, North Carolina 28403          (910) 791-6707 (O) (910) 791-6760 (F)          NC License #: C-2846</p>	<p><b>CLIENT INFORMATION:</b></p> <p>BECKER MORGAN GROUP          3205 RANDALL PKWY., #211          WILMINGTON, NC 28403</p>	<p><b>REVISIONS:</b></p> <table border="1"> <thead> <tr> <th>NO.</th> <th>REVISION</th> <th>DATE</th> </tr> </thead> <tbody> <tr> <td>1.</td> <td>REVISED PER COW COMMENTS</td> <td>6/18/18</td> </tr> </tbody> </table>	NO.	REVISION	DATE	1.	REVISED PER COW COMMENTS	6/18/18
NO.	REVISION	DATE									
1.	REVISED PER COW COMMENTS	6/18/18									

